

DAIKIN

OPERATING MANUAL



Operating Manual
Handset Wired

English

Bedienungsanleitung
Verdrahtetes Handgerät

Deutsch

Mode D'emploi
Combiné Câblé

Français

Bedieningsaanwijzing
Bedraad Handapparaat

Nederlands

Manual De Instrucciones
Auricular Alámbrico

Español

Manuale Di Funzionamento
Ricevitore Cablato

Italiano

Εγχειρίδιο Οδηγιών
Ασύρματη Χειροσυσκευή

Ελληνικά

Manual De Funcionamento
Aparelho Conectado

Portugues

Руководство По Эксплуатации
Проводное Дистанционное Управление

Русский

Kullanım Kılavuzu
Kablolu Kumanda

Türkçe

OM-G17-0808-DAIKIN (DENV)
Part No.: R08019032312



**G17 Remote Controller Indication /
G17-Remote-Controller-Anzeige / Indication De
Télécommande G17 / G17 Indicatie afstandsbediening /
Indicación Del Mando A Distancia G17 / Indicazione
Controller Remoto G17 / Δείκτης τηλεχειριστηρίου
G17 / Indicador do Controlo Remoto G17 / Пульт
Дистанционного Управления G17 Индикация /
G17 Uzaktan Kumanda Göstergesi**

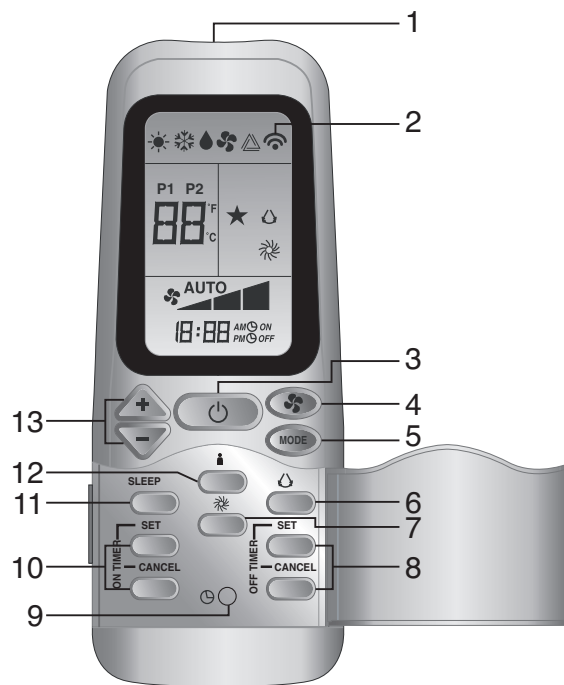



HOW TO MOUNT ONTO THE WALL / ANBRINGEN DER FERNSTEUERUNG AN DER WAND / COMMENT INSTALLER SUR LE MUR / MONTAGE OP DE MUUR / MONTAJE SOBRE LA PARED / COME FISSARE L'ASTUCCIO DEL TELECOMANDO ALLA PARETE / ΠΩΣ ΝΑ ΤΟ ΤΟΠΟΘΕΤΗΣΕΤΕ ΠΑΝΩ ΣΤΟΝ ΤΟΙΧΟ / FIXAÇÃO DO APARELHO NA PAREDE / КАК УСТАНОВИТЬ НА СТЕНЫ / DUVARA NASIL YERLEŞTİRİLİR



TO INSERT BATTERIES (AAA.R03) / EINSETZEN DER BATTERIEN (AAA.R03) / INTRODUIRE LES PILES (AAA.R03) / BATTERIJEN INZETTEN (AAA.R03) / INSERTE LAS PILAS (AAA.R03) / INSERIMENTO DELLE BATTERIE (AAA.R03) / ΓΙΑ ΝΑ ΕΙΣΑΓΕΤΕ ΤΙΣ ΜΠΑΤΑΡΙΕΣ (AAA.R03) / PARA INTRODUIZIR AS PILHAS (AAA.R03) / УСТАНОВКА БАТАРЕЙ (AAA.R03) / PİLLER NASIL TAKILIR (AAA.R03)

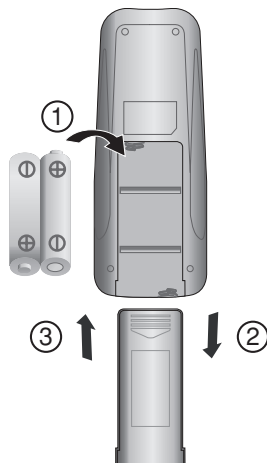

ii





Battery

- 1) Type: AAA.R03
- 2) Quantity: 2 pieces

Disposal Requirements

The batteries supplied with the controller are marked with this symbol.
This means that the batteries shall not be mixed with unsorted household waste.
If a chemical symbol is printed beneath the symbol, this chemical symbol means that the battery contains a heavy metal above a certain concentration.
Possible chemical symbols are:
■ Pb: lead (>0,004%)
Waste batteries must be treated at a specialized treatment facility for re-use. By ensuring correct disposal, you will help to prevent potential negative consequences for the environment and human health. Please contact your local authority for more information.

Batterie

- 1) Typ: AAA.R03
- 2) Menge: 2 Stück

Vorschriften zur Entsorgung

Die mit dem Steuergerät mitgelieferten Batterien sind mit diesem Symbol gekennzeichnet.
Das bedeutet, dass die Batterien nicht in unsortierten Hausmüll entsorgt werden dürfen.
Befindet sich unter dem Symbol ein chemisches Symbol, so bedeutet dieses chemische Symbol, dass die Batterie Schwermetall oberhalb einer bestimmten Konzentrationsgrenze enthält.
Mögliche Symbole für Chemikalien:
■ Pb: Blei (>0,004%)
Leere Batterien werden in einer speziellen Aufbereitungsanlage verarbeitet. Mit einer korrekten Entsorgung helfen Sie, möglichen negativen Folgen für die Umwelt und die menschliche Gesundheit vorzubeugen. Fragen Sie Ihre Behörde vor Ort nach weiteren Informationen.

Pile

- 1) Type: AAA.R03
- 2) Quantité: 2 pièces

Instructions d'élimination

Les piles fournies avec le contrôleur sont marquées de ce symbole.
Il signifie que les piles doivent être éliminées séparément des ordures ménagères non triées.
Si un symbole chimique est imprimé sous ce symbole, il signifie que la pile contient un métal lourd au-delà d'une certaine concentration.
Symboles chimiques possibles:
■ Pb: plomb (>0,004%)
Les piles usagées doivent être traitées par une usine de traitement spécialisée dans le recyclage. À travers une mise au rebut correcte, vous contribuez à éviter les conséquences potentiellement néfastes pour l'environnement et la santé humaine. Veuillez contacter votre autorité locale pour plus d'informations.

Batterij

- 1) Type: AAA.R03
- 2) Hoeveelheid: 2 Stuks

Vereisten voor het opruimen

De batterijen, die met de bediening meegeleverd werden, zijn met dit symbool gekenmerkt.
Dit betekent, dat de batterijen niet samen met ongesorteerde huisafval verwijderd mogen worden.
Indien beneden het symbool een chemisch symbool gedrukt is, betekent dit, dat de batterij een zwaar metaal bevat boven een bepaalde concentratie.
Mogelijke chemische symbolen:
■ Pb: lood (>0,004%)
Atvalbatterijen moeten in een special behandelingsbedrijf voor hergebruik bewerkt worden. Door voor een correcte afvalverwijdering te zorgen, draagt u ertoe bij, potentiële negatieve consequenties voor milieu en volkgezondheid te vermijden. Neem a.u.b. contact op met uw plaatselijke instanties voor meer informatie.

Batería

- 1) Tipo: AAA.R03
- 2) Cantidad: 2 piezas

Requisitos para la eliminación

Las baterías suministradas con el controlador están marcadas con este símbolo.
Esto significa que las baterías no se deben mezclar con los desechos del hogar no clasificados.
Si un símbolo químico está impreso abajo del símbolo, este símbolo químico significa que la batería contiene un metal pesado sobre una cierta concentración.
Estos son los posibles símbolos químicos:
■ Pb: plomo (>0,004%)
Las baterías gastadas deben ser tratadas en una instalación de tratamiento especializada para volver a usarlas. Al asegurar la eliminación correcta de estas baterías, ayudará a evitar consecuencias negativas potenciales para el ambiente y la salud humana. Comuníquese con su autoridad local para obtener más información.

Batteria

- 1) Tipo: AAA.R03
- 2) Quantità: 2 pezzi

Istruzioni per lo smaltimento

Le batterie fornite con il comando a distanza sono contrassegnate da questo simbolo.
Ciò vuol dire che le batterie non devono essere mischiate nei rifiuti domestici non separati.
Se un simbolo chimico è stampato sotto all'immagine, esso vuol dire che le batterie contengono un metallo pesante che supera una determinata concentrazione.
I simboli chimici possibili sono:
■ Pb: piombo (>0,004%)
I rifiuti costituiti da batterie devono essere portati presso strutture di trattamento specializzate adatte al loro utilizzo. Adottando la corretta procedura di smaltimento, contribuirete ad evitare effetti negativi potenziali sull'ambiente e sulla salute umana. Per maggiori informazioni, rivolgersi all'autorità locale.

Μπαταρία

- 1) Τύπος: AAA.R03
- 2) Ποσότητα: 2 τεμάχια

Προϋποθέσεις απόρριψης

Οι μπαταρίες που συνοδεύουν το χειριστήριο φέρουν αυτό το σύμβολο.
Αυτό σημαίνει ότι οι μπαταρίες δεν θα ανακατευτούν με άλλα οικιακά απόβλητα.
Αν ένα χημικό σύμβολο είναι τυπωμένο κάτω από το σύμβολο, τότε αυτό το χημικό σύμβολο σημαίνει ότι η μπαταρία περιέχει βαρύ μέταλλο πάνω από ορισμένη συγκέντρωση.
Πιθανά χημικά σύμβολα είναι:
■ Pb: μολύβδος (>0,004%)
Η επεξεργασία των απόβλητων μπαταριών πρέπει να γίνεται σε ειδικό εργοστάσιο επαναχρησιμοποίησης. Διασφαλίζοντας τη σωστή απόθεση, θα βοηθήσετε στην αποφυγή πιθανών αρνητικών συνεπειών για το περιβάλλον και την ανθρώπινη υγεία. Παρακαλώ επικοινωνήστε με την τοπική αρχή για περισσότερες πληροφορίες.

Bateria

- 1) Tipo: AAA.R03
- 2) Quantidade: 2 peças

Requisitos para a eliminação

As baterias fornecidas com o controlador estão marcadas com este símbolo.
Isto significa que as baterias não devem ser misturadas com o lixo doméstico.
Se um símbolo químico está impresso abaixo do símbolo, significa que a bateria contém um metal pesado com uma certa concentração.
Possíveis símbolos de produtos químicos:
■ Pb: chumbo (>0,004%)
A eliminação de baterias deve ser tratada em instalações de tratamento especializadas para reutilização. Ao assegurar-se da correta eliminação, você está a ajudar a prevenir potenciais consequências negativas para o ambiente e para a saúde humana. Por favor contacte as autoridades locais para mais informações.

Батарея

- 1) Тип: AAA.R03
- 2) Количество: 2 штуки

Утилизация отходов

На батареи, которые входят в комплект поставки контроллера, нанесен данный символ.
Это означает, что батареи нельзя утилизировать вместе с несортированными бытовыми отходами.
Если ниже символа нанесен знак химического элемента, он означает, что в батарее содержится тяжелые металлы выше определенной концентрации.
Встречающиеся химические знаки:
■ Pb: свинец (>0,004%)
Утилизируемые батареи должны перерабатываться на специальном перерабатывающем предприятии для их повторного использования. Обеспечив правильное утилизацию, Вы сможете предотвратить потенциальные негативные последствия для окружающей среды и здоровья людей. Для получения дополнительной информации, пожалуйста, обратитесь в местные органы власти.

Pij





- 1) Tip: AAA.R03
- 2) Miksar: 2 adet

Bertaraf gereskinimleri

Kumandayla birlikteler verilen piller bu sembole işaretilenmiştir.
Bu pillerin sınıflandırılması ev atığı olarak kategorize edilmesi gerektiği anlamına gelir.
Sembolün altında bir kimyasal sembol varsa, bu kimyasal sembol piller belirli bir konsantrasyonun üstünde ağır bir metal içerdiği anlamına gelir.
Olası kimyasal semboller şunlardır:
■ Pb: kurşun (>0,004%)
Atık piller yeniden kullanılmaları için özel bir işlem tesisinde işlemlenmelidir. Doğru atılmasını sağlayarak çevre ve insan sağlığı için olası olumsuz sonuçların önlenmesine yardımcı olacaksınız. Daha fazla bilgi için lütfen yerel makamlarla temasa geçiniz.



OPERATING GUIDE

1. **Transmission source**
 - The source where the signal will be transmitted.
2. **Signal transmission indication**
 - Blink to confirm that the last setting has been transmitted to the unit.
3. **“ON/OFF” Button**
 - Press once to start the air conditioner unit.
 - Press again to stop the unit.
4. **Fan speed selection**
 - Press the  button continuously will toggle the fan speed in the following order:
Low → Med → High → Auto
 - Stop pressing when the desired fan speed appears on the display screen.
5. **Operation mode**
 - Press the **MODE** button to select the type of operating mode.
 - For cooling only unit, the available modes are: **COOL** (✳), **DRY** (💧) and **FAN** (🌀).
 - For heat pump unit, the available modes are: **AUTO** (△), **COOL** (✳), **DRY** (💧), **FAN** (🌀) and **HEAT** (☀).
 - The **AUTO** (△) mode is unavailable for chilled water 2-pipe system.
6. **Automatic air swing (optional)**
 - Press the **SWING** (↻) button to activate the automatic air swing function.
 - To distribute the air to a specific direction, press the **SWING** (↻) button and wait until the louver move to the desired direction and press the button once again.
7. **Turbo function**
 - Press  for fast cooling or heating operation.
 - Fan speed turn to maximum speed.
 - Press again to deactivate the function.
 - Available under Heat, Cool and Dry modes only.
 - The Turbo function () is unavailable for chilled water system.
8. **OFF timer setting**
 - Press the **SET** button will activate the off timer function.
 - Set the desired off time by pressing the **SET** button continuously.
 - Press the **CANCEL** button to cancel the off timer setting.
9. **Clock time setting**
 - Press and hold  button to set the clock time.



10. ON timer setting

- Press the **SET** button will activate the on timer function.
- Set the desired on time by pressing the **SET** button continuously. If the timer is set to 7.30am, the air conditioner will turn on at 7.30am sharp.
- Press the **CANCEL** button to cancel the on timer setting.

11. Sleep mode setting

- Press the **SLEEP** button will activate the sleep mode function.
- This is an energy saving option. When the unit is operating under cooling mode, the set temperature is increased by 0.5°C after the first half an hour, another 0.5°C after the second half an hour and 1°C after the following 1 hour.
- When the unit is operating under heating mode, the set temperature is decreased by 1°C after the first half an hour, another 1°C after the second half an hour and 1°C after the following 1 hour.

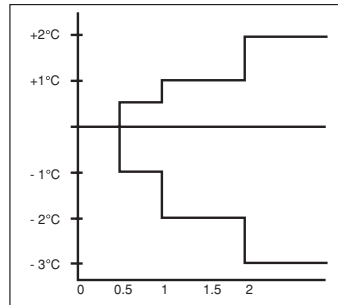

- This function is available under **COOL**, **HEAT** and **AUTO** mode.

12. Personalize setting

- Press and hold for 3s, then will blink. Press again to cycle between and .
- Set the desire setting, then leave the handset for 4s without pressing any key and it will save the setting into the programme.
- Press once to activate the P1 setting, press again to cycle between P1 and P2.
- Press any key to deactivate the personalize setting.

13. Temperature setting

- To set the desired room temperature, press the + or - button to increase or decrease the set temperature.
- The temperature setting range is from 16°C to 30°C (Optional setting 20°C to 30°C).
- Press both buttons simultaneously to toggle + and - from °C to °F setting.



**MEMO / MITTEILUNG / LE MÉMO / MEMO /
EL MEMORÁNDUM / PROMEMORIA / ΣΗΜΕΙΩΜΑ /
MEMO / ПАМЯТКА / NOT**





DAIKIN INDUSTRIES, LTD.

Head office:
Umeda Center Bldg., 2-4-12, Nakazaki-Nishi,
Kita-ku, Osaka, 530-8323 Japan

Tokyo office:
JR Shinagawa East Bldg., 2-18-1, Konan,
Minato-ku, Tokyo, 108-0075 Japan
<http://www.daikin.com/global/>

DAIKIN EUROPE NV

Zandvoordestraat 300, B-8400 Oostende, Belgium



Part No.: R08019032312

